



SOFTWARE FENOM FLO v3.0.2 Release & Installation Notice

GENERAL INFORMATION

| | |
|-----------------------------|--------------------|
| Software Name / Product ID: | Fenom Flo |
| Version / Build Number: | 3.0.2 |
| Release Date: | 1/26/26 |
| Released By: | Tracy M. Pederson |
| Regulatory Region(s): | US. |
| Release Type: | Major |
| Applicable Device(s): | Fenom Flo Hardware |

RELEASE NOTICE

The Fenom Flo software is intended to provide a user interface to enable FeNO testing with the Fenom Flo Device in an environment where sampling and testing are performed in the presence or near presence of the patient and support all other use cases related to configuration, data transfer, etc.

Minimum System Requirements:

| | |
|------------------------------|---|
| Required Operating System | Windows 10 or 11 (Pro, Enterprise, or LTSC) |
| .NET Desktop Runtime Package | Microsoft .NET 6.0 |
| Processor | Intel Dual Core or Greater |
| Memory | 16 GB Recommended 4 GB Minimum |
| Display | 1920 x 1080 Resolution Recommended 1024 x 768 Resolution Minimum |
| System Type | x64 (64-Bit) Recommended |
| Bluetooth | Bluetooth version 4.0 or greater |

.NET Desktop Runtime 6.0 can be loaded from the website below and selecting x64:

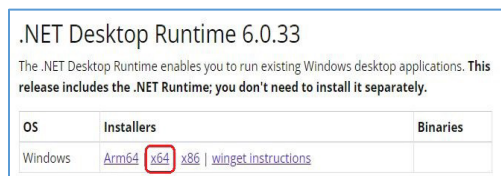

<https://dotnet.microsoft.com/en-us/download/dotnet/6.0> and selecting x64

CAUTIONS & WARNINGS

Changes Made in v3.0.2 Software Release

- Remove CE Mark and add UDI# where CE mark Used to be
- Change Manufacturer to MGC Diagnostics U.S.

INSTALLATION INSTRUCTIONS

1. Browse to the Fenom Flo Installation media and double-click the file to run the installation.

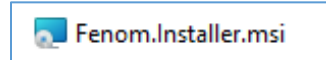

2. Select 'Next' on the Setup Wizard to start installation.



3. Accept the License Agreement and select 'Next.'

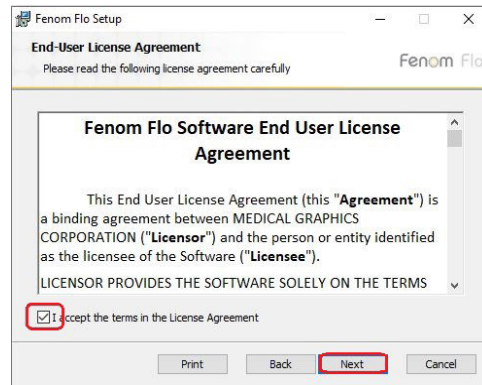

- i. Place a checkmark next to the appropriate box if you want the application to be available from the Start Menu and/or a shortcut placed on the desktop, and then select Next.

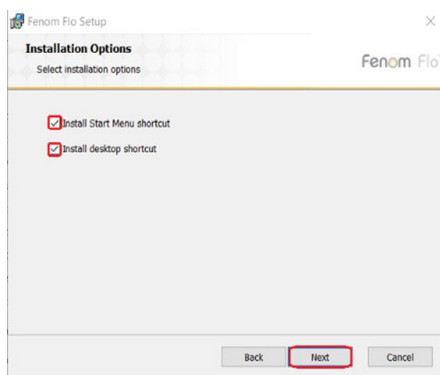

- ii. Select 'Install' to begin the installation of the Fenom Flo software.

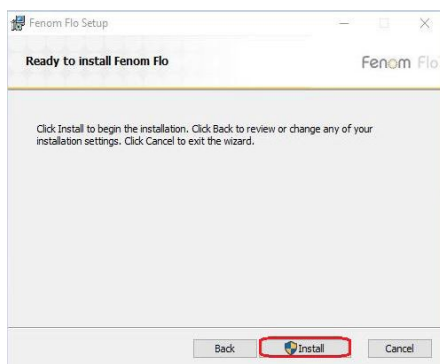

- iii. After installation, place a checkmark in the Launch Fenom Flo checkbox if you want to run the application immediately upon finishing the setup. Then, select 'Finish' to complete the installation process.

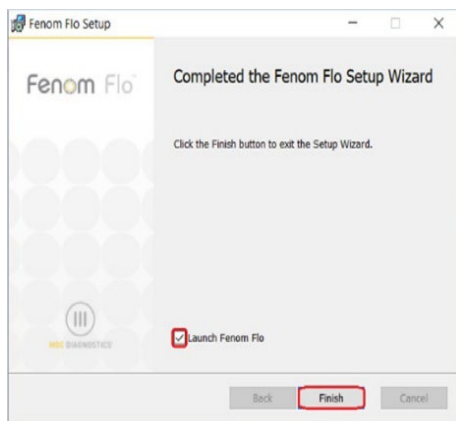

4. The Fenom Flo application installation is complete

Language Translations

English, French, Spanish, German, Italian, Polish and Dutch